

3 DETAIL AT CONCRETE SLAB / WALL
SCALE 3" = 1'-0"

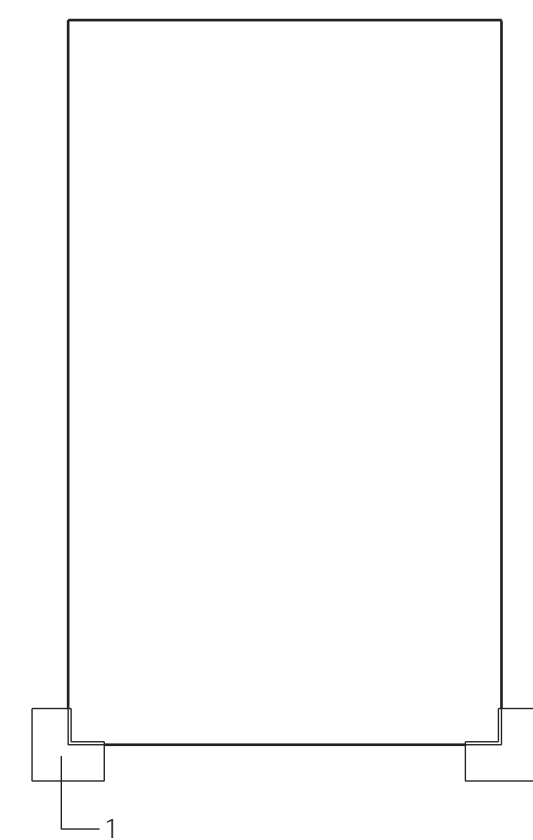

STEP 1

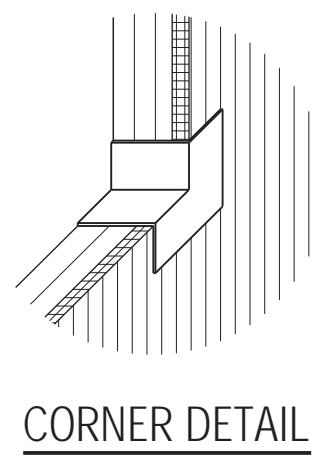

CORNER DETAIL

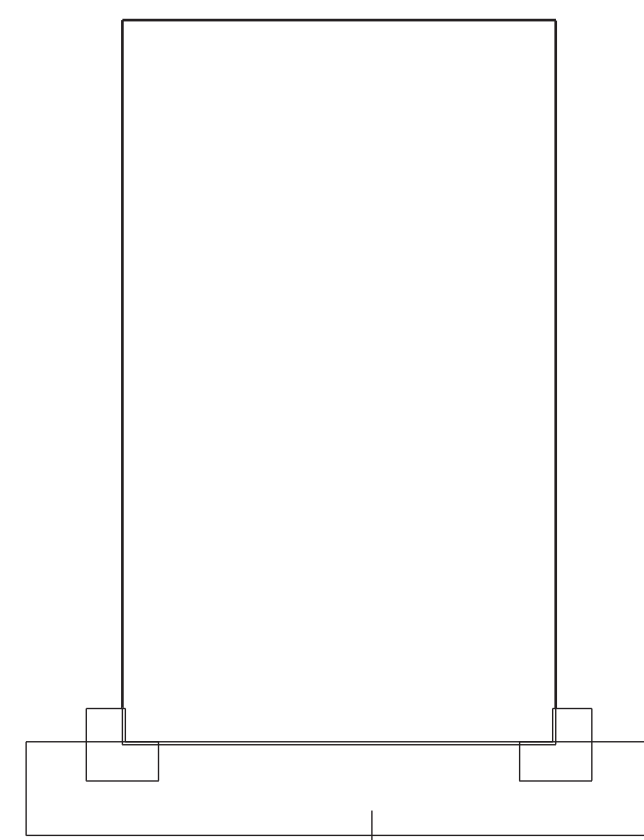

STEP 2

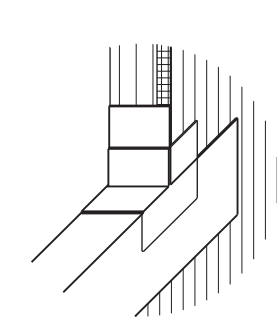

CORNER DETAIL

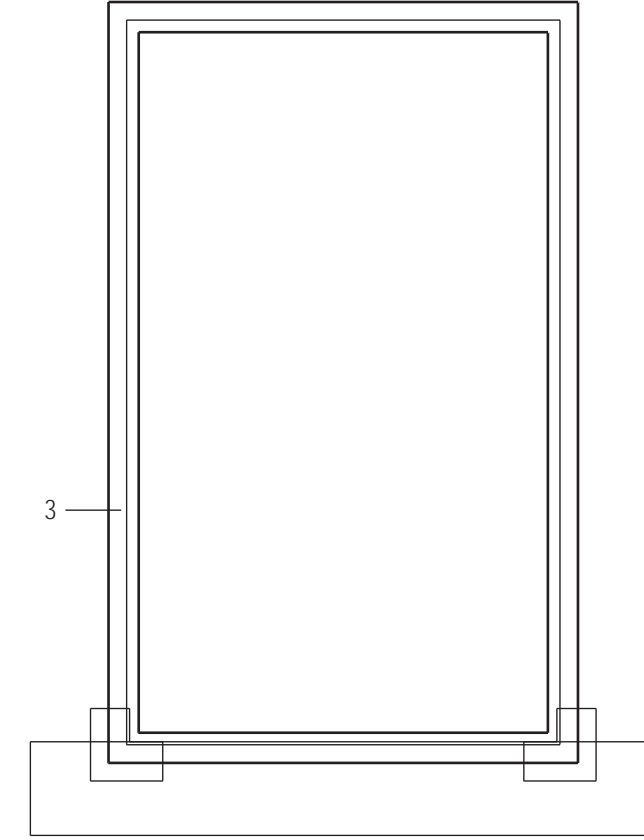

STEP 3

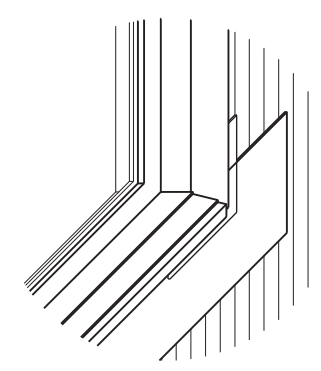

CORNER DETAIL

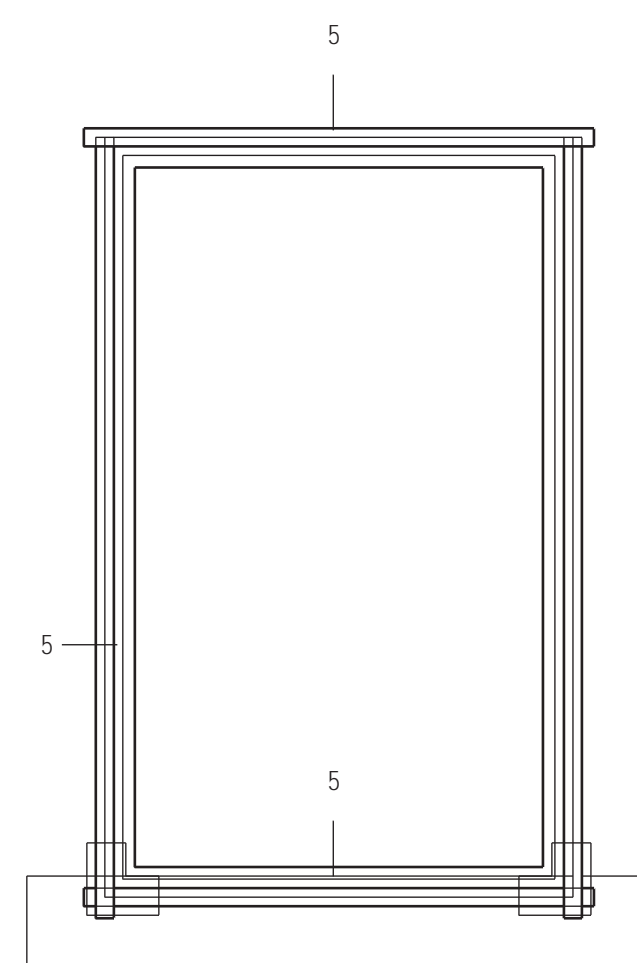

STEP 5

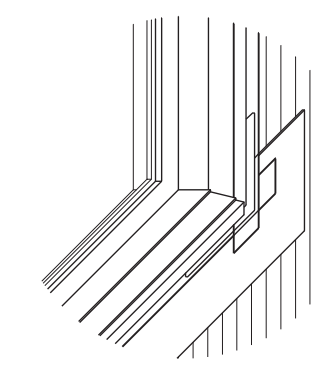

CORNER DETAIL

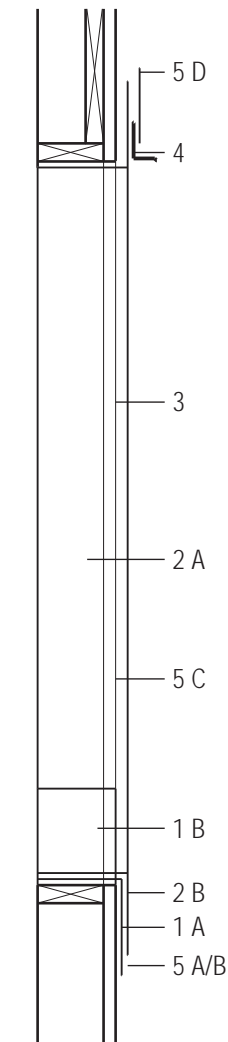

SECTION

1. A - INSTALL MEMBRANE CORNER PATCHES
B - FOLD ENDS AT JAMBS
C - ENSURE MEMBRANE EXTENDS TO FULL CAPACITY ON EXTERIOR FACE OF WALL
2. A - INSTALL ADHESIVE MEMBRANE STRIP AT WINDOW SILL
B - LAP SILL MEMBRANE OVER CORNER PATCH MEMBRANE ON EXTERIOR FACE OF WALL
C - ENSURE MEMBRANE EXTENDS MINIMUM OF 6" BEYOND SILL ON EXTERIOR FACE OF WALL
3. A - ENSURE A CONTINUOUS BEAD OF SEALANT IS APPLIED TO BACK SIDE OF NAILING FLANGE OF WINDOW ON EXTERIOR FACE OF WALL
B - INSTALL WINDOW (ACCORDING TO MANUFACTURER SPECIFICATIONS)
4. A - INSTALL HEAD FLASHING
B - ENSURE HEAD FLASHING IS AT LEAST AS WIDE AS WINDOW UNIT
5. A - INSTALL ADHESIVE MEMBRANE STRIP OVER WINDOW FLANGE AND EXTERIOR FACE OF WALL IN ORDER:
B - INSTALL ADHESIVE MEMBRANE OVER BOTTOM WINDOW FLANGE AND EXTERIOR FACE OF WALL
C - INSTALL ADHESIVE MEMBRANE OVER WINDOW JAMB FLANGE AND EXTERIOR FACE OF WALL
D - INSTALL ADHESIVE MEMBRANE OVER HEAD FLASHING, JAMB MEMBRANE, AND EXTERIOR FACE OF WALL

GENERAL NOTES
A - ENSURE ALL SURFACES TO RECEIVE MEMBRANE FLASHING ARE CLEAN AND DRY
B - ENSURE MEMBRANE IS WELL SEATED AGAINST EXTERIOR SHEATHING - EXERCISE CARE SO AS TO REDUCE ANY UNNEEDED WRINKLES IN APPLIED MEMBRANES

2 DETAILS AT WINDOW FLASHING
SCALE 3/4" = 1'-0"

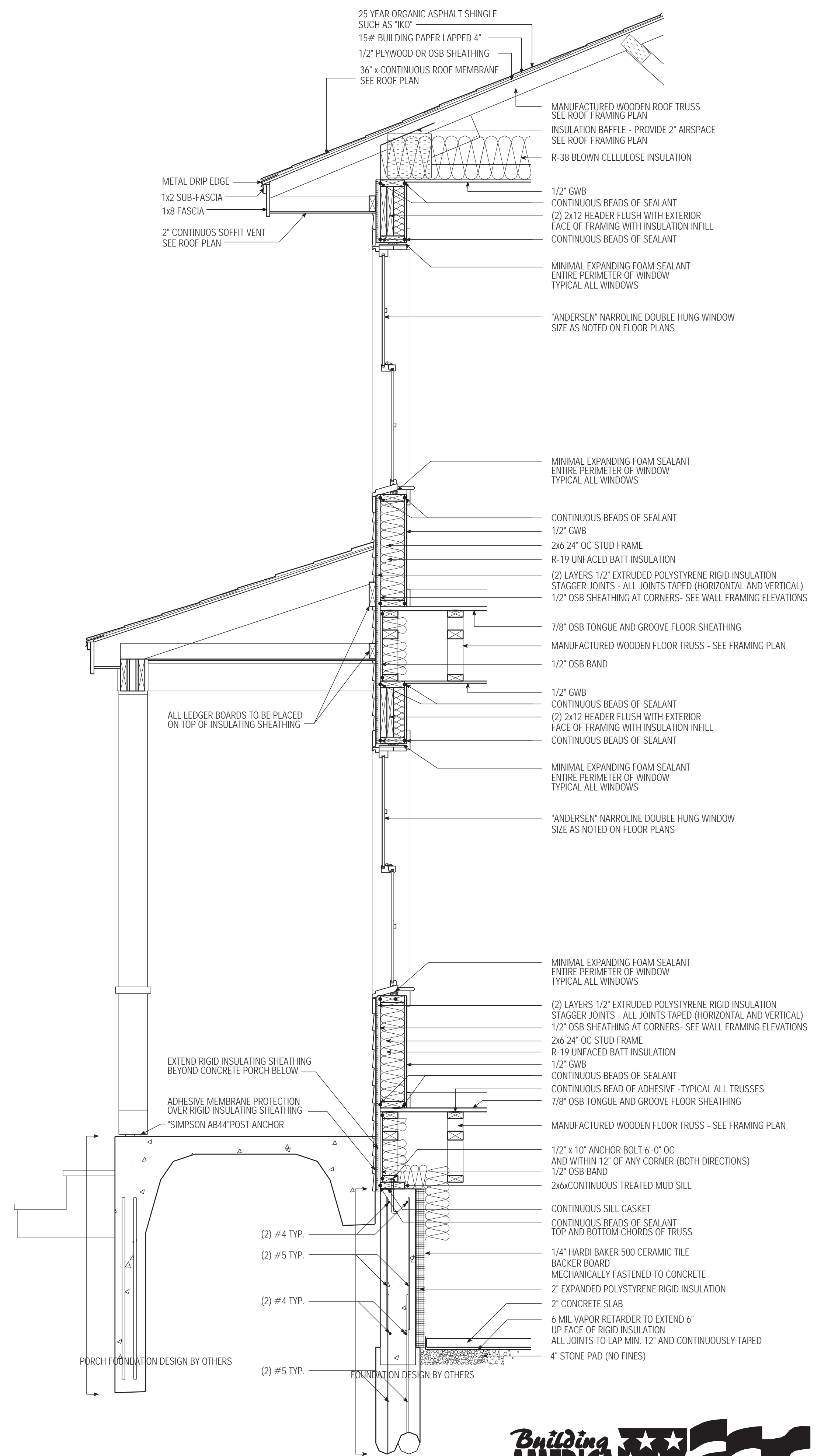

1 WALL SECTION
SCALE 3/4" = 1'-0"

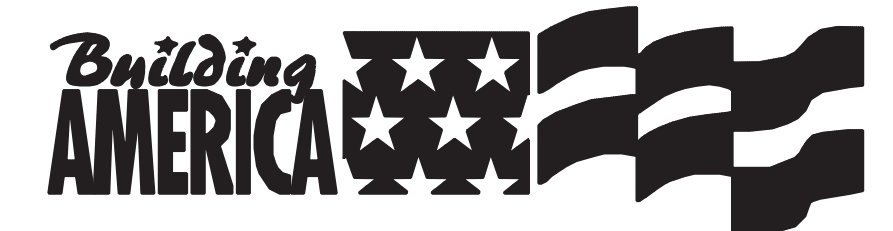

1/22/01 SUBMITTED FOR REVIEW

BUILDING SCIENCE CORPORATION
AND BETSY PETTIT ARCHITECTS
70 MAIN STREET WESTFORD, MASSACHUSETTS 01886
P: 978-689-5100 F: 978-689-5103

HABITAT FOR HUMANITY
METRO DENVER
13TH AVENUE AND NELSON STREET, LAKE WOOD CO

WALL SECTION
HVAC DUCT LAYOUT
HOUSE 2
SCALE AS NOTED

COPYRIGHT © 2001
BUILDING SCIENCE CORPORATION

A-9

FILE: HJ METRO_02b.dwg (10/28/00)